

RoHS2.0  
Compliant ✓

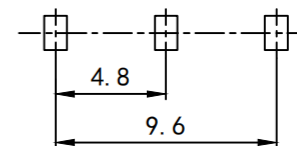

P. C. B LAYOUT  
BOTTOM VIEW

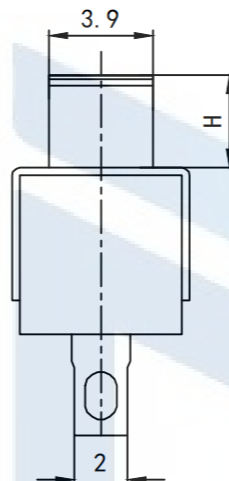
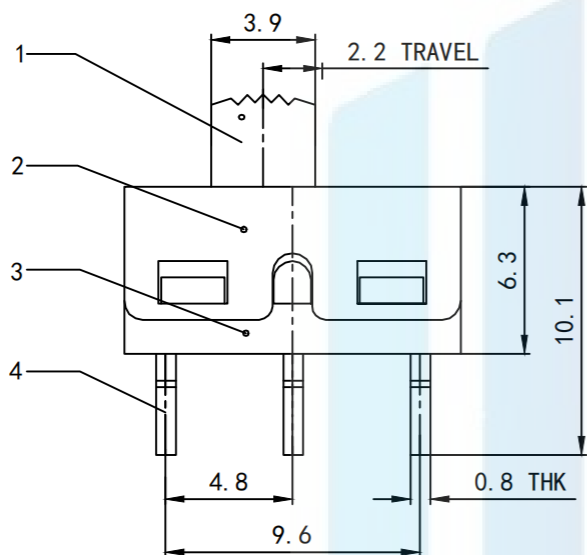
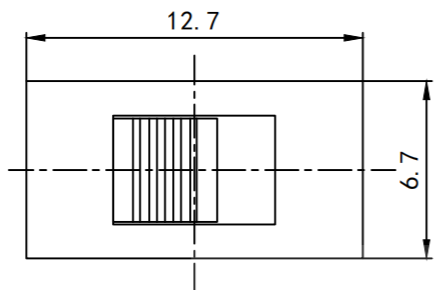
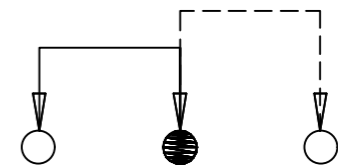

SCHEMATIC (NON-SHORTING)

Electrical performance parameters:

1. Rated load : AC125V 3A
2. Contact resistance: less than 100 milliohm
3. Insulation resistance: more than 100 megohm
4. Pressure resistance : AC 500V
5. Strength :  $350 \pm 100$ gf
6. Life span : 5000 times
7. Wave peak welding :  $255 \pm 5$  degrees

TOLERANCE

X. XXX	$\pm 0.05$
X. XX	$\pm 0.15$
X. X	$\pm 0.20$
X.	$\pm 0.30$
ANGLE	$\pm 5.0^\circ$

PROTECTON

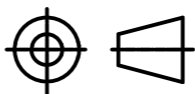

东莞市恒祺电子科技有限公司

Dongguan Hengqi Electronic Technology Co., Ltd

<https://www.hq-dz.com>

phone: 15812872448

TITLE:

拨动开关

PART NO: SS-12D10孔脚

DRAWING NO: 12.7\*6.7\*H

DRAWN:

DATE:

18-10-08

UNIT:  
mm

CHECKED:

DATE:

18-10-08

SCALE:  
FULL

APPROVED:

DATE:

18-10-08

SIZE:  
A4